

KNIPEX Cobra®...matic

High-Tech Water Pump Pliers
DIN ISO 8976

87
1

All features of the KNIPEX Cobra® 87 01 250 along with these special features:

- > automatic adjustment at the touch of a button directly on the workpiece
- > the securely positioned spring ensures that the pliers close automatically once the push-button is activated (one-hand operation!)
- > chrome vanadium electric steel; forged, multi stage oil-hardened



87 11 250



Product Number	Packaging	↔ Inch mm		Pliers	Head	Handles	⊘ Inch Ø mm	⬡ Inch mm	Adjustment positions	⚖ lbs
87 11 250	X	10 250		grey atramentized	polished	non-slip plastic coated	2 50	1 13/16 46	25	0.75
87 19 250	Spare spring for 87 11 250									

KNIPEX Cobra® QuickSet

High-Tech Water Pump Pliers
DIN ISO 8976

87
2

Fully open, push, grab!

Fast adjustment on the workpiece by sliding the pliers handle

- > combines the proven, reliable locking of the hinge bolt with an additional push function which makes it easier to work in very confined and inaccessible areas
- > adjustment directly on the workpiece by sliding the pliers handle
- > reliable locking of the hinge bolt with the first workload. The gripping width of the pliers is then fixed and can only be adjusted by pressing the button
- > the pliers stay locked in place and can only be readjusted by pressing the button and resetting
- > chrome vanadium electric steel; forged, multi stage oil-hardened



87 21 250



87 21 300



87 22 250



Press the button – open pliers completely

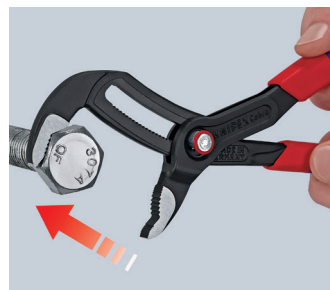

Position top jaw and simply slide and close pliers

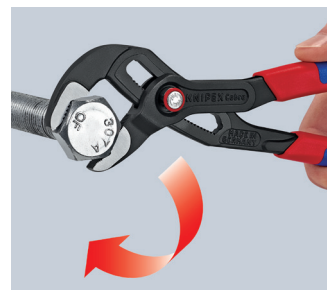

The push-button stays locked in place once the handles are squeezed

Proven Cobra® functions

- > self-locking on pipes and nuts: no slipping off the workpiece and low handforce required
- > fine adjustment for optimum adaptation to different size workpieces and a comfortable handle width

Product Number	Packaging	↔ Inch mm		Pliers	Head	Handles	⊘ Inch Ø mm	⬡ Inch mm	Adjustment positions	⚖ lbs
87 21 250	X	10 250		grey atramentized	polished	non-slip plastic coated	2 50	1 3/4 46	25	0.74
87 21 300	X	12 300					2 3/4 70	2 3/64 60	25	1.20
87 22 250	X	10 250		grey atramentized	polished	slim multi-component grips	2 50	1 3/4 46	25	0.81